

HOTEL SERVICES

Directory



OCEANFRONT AND 54TH STREET | OCEAN CITY, MARYLAND

HOTEL GUEST DIRECTORY



It is our pleasure to have you as our guest and to welcome you to Ocean City, Maryland.

We want to assure you that your stay with us is comfortable and relaxing. If you have any questions or need assistance please don't hesitate to ask one of our courteous staff members for help.

Our management and staff are committed to ensuring that your needs are met. We thank you for giving us the opportunity to serve you. Our beaches are wide and our ocean is blue so relax and have a wonderful time while you're here with us.

OCEANFRONT & 54TH STREET
5400 COASTAL HWY | OCEAN CITY, MD 21842
410-524-7200 | WWW.QIOCEANFRONT.COM



IN ROOM FEATURES

HIGH-SPEED WIRELESS INTERNET ACCESS

CONNECT TO THE WIRELESS: For wireless use in guest rooms, hotel lobby, business center, meeting rooms and any public areas: Using your device's wireless connection, search for wireless networks and connect to your venue's network name or SSID. Proceed to sign-in.

SIGNING IN: Third-party software security enhancements may prevent your device from reaching the login page. Open your web browser and visit a non-HTTPS page such as wifi123.org . You will be directed automatically to the sign-in page. Once you read and agree to the Terms of Service, enter the access code provided by the front desk and the click "I Agree." You will then be redirected to the Home Page and allowed to use the internet.

TROUBLE CONNECTING: Guest WiFi networks require you to login. If you are having issues connecting to the WiFi, it is always best to reboot your device and try reconnecting. This clears any previous connections and should allow you to reach the login page.

GAME CONSOLE AND STREAMING MEDIA BOXES: If you are traveling with an Xbox, PlayStation, Roku, Apple TV or other media device and are having problems connecting, please locate the MAC address and call our support team to have your device authenticated.

24-HOUR TECHNICAL SUPPORT
(866) 438-0216

TV CHANNELS

007-1	Scrolling TV Guide	SD	028-1	Fox News	HD	048-1	FX	HD
009-1	WBAL / NBC	HD	029-1	CNN	HD	049-1	NBC Sports Network	HD
010-1	WBOX / FOX	SD	030-1	Headline News (CNN)	HD	050-1	FS1	HD
011-1	WBOC / CBS (local)	HD	031-1	MSNBC	HD	051-1	AMC	HD
012-1	WCPB / MPT	HD	032-1	CNBC	HD	052-1	Bravo	HD
013-1	WFDC	SD	033-1	The Weather Channel	HD	053-1	Cartoon	HD
014-1	WJZ	SD	034-1	USA	HD	054-1	History Channel	HD
015-1	WMDO	SD	035-1	TNT	HD	055-1	Spike TV	HD
016-1	WMDT / ABC (local)	HD	036-1	TBS	HD	056-1	Comedy Channel	HD
017-1	WQAQ-LP	SD	037-1	A&E	HD	057-1	Animal Planet	HD
018-1	WRDE (local)	HD	038-1	HGTV	HD	058-1	Syfy Channel	HD
019-1	WTTG	HD	039-1	Food Network	HD	059-1	Bloomberg Television	HD
020-1	WZDC	SD	040-1	Lifetime	HD	060-1	BBC America	HD
021-1	HBO	HD	041-1	MTV	HD	061-1	Fox Business	HD
022-1	MASN	SD	042-1	TLC	HD	062-1	TRU TV	HD
023-1	CSNMA	SD	043-1	Disney	HD	063-1	E!	HD
024-1	BTN	SD	044-1	Nickelodeon	HD	064-1	BET	HD
025-1	ESPN	HD	045-1	ABC Family	HD	065-1	VH1	HD
026-1	ESPN2	HD	046-1	Discovery	HD	066-1	Esquire	HD
027-1	The Golf Channel	HD	047-1	Travel	HD			

DIRECTORY OF SERVICES

AIRPORTS

OCEAN CITY MUNICIPAL AIRPORT .. 410-213-2471

Located approximately 3 miles west of town on Rt. 611 (Stephen Decatur Memorial Rd.) Charter and regularly scheduled flights leave and arrive daily.

SALISBURY/OCEAN CITY/WICOMICO REGIONAL AIRPORT 410-742-4190

Located off Mt. Hermon Rd., east of Salisbury with charter and regularly scheduled flights to Baltimore and Washington.

AIR CONDITIONING & HEATING

Before attempting to turn on the air conditioner or heat, please be sure to close the windows and doors. Leaving these open will automatically shut-off the heating or cooling unit.

ALCOHOLIC BEVERAGES

Consumption of alcoholic beverages in public areas other than those specified is prohibited. No glass containers in Atrium or pool areas.

BELLMAN EXT. 0

Should you desire a bellman to help you with your luggage, either place a request at the front desk or call above number.

CHURCH SERVICES EXT. 0

You may wish to consult our listing of nearby churches, or refer to page 3 of this directory.

CHECK-OUT TIME

Check-out time is 11:00AM. Please leave keys at the front desk.

CREDIT CARDS

American Express, Visa, Mastercard, Carte Blanche, Diner's Club and Discover Card are accepted.

CRIBS & HIGHCHAIRS DIAL EXT. 0

Provided at no extra charge.

EMERGENCY EXT. 0

Please contact the manager on duty or call the operator.

EQUIPMENT RENTAL

Tennis racquets and balls and various other recreational equipment is available for a refundable deposit.

EXERCISE ROOM

Located in the basement of the oceanfront building. Hours are 6:00AM - 11:00PM daily. Limited to guests 18 years or older.

FREE

Coffee, tea, hot chocolate, fresh fruit and the morning newspaper (except Sunday) is available to you as a guest of the hotel.

PARKING

Ample free parking is provided for all our guests. One permit per room.

FRONT DESK EXT. 0

GAME ROOM

Located in the basement of the building. Hours are 8:00AM - 11:00PM.

GUEST LAUNDRY

Located on the north end of the oceanfront building on the second floor. Machines are free of charge, open 24 hours, detergent available at the desk for 50 cents a box.

HOUSEKEEPING EXT. 0

HOTEL OPERATOR EXT. 0

ICE

Automatic ice machines are located in the guest laundry at the north end of the oceanfront building, the south end fourth floor oceanfront, and on the second floor of the Atrium building. Ice buckets are provided in the rooms.

INDOOR POOL

A heated pool, baby pool, saunas and hot tubs are located on the main floor of the Atrium. Pool hours are 9:00AM - 10:00PM daily. Swim at your own risk.

IRON AND IRONING BOARD

In every guest room.

LOCAL TOUR INFORMATION

Inquire at the front desk.

LOST & FOUND EXT. 0

MAINTENANCE PROBLEMS EXT. 0

We like the best for our guests, so please, no matter how minor, report any problems to the front desk.

MESSAGES EXT. 0

To leave or receive messages.

MANAGER ON DUTY EXT. 0

NOISE CONTROL

Please respect the rights of the other guests who wish a quiet and restful stay!

OUTDOOR RECREATIONAL FACILITIES

An outdoor pool, tennis court, barbecue grills and playground area for the children are all located on the premises.

PETS

We are sorry, we do not have accommodations for pets. If you are traveling with your pet, we can recommend a nearby kennel for your pet's board.

PHONE CALLS

Local calls and 1-800 calls are free. There is a charge for credit card and operator assisted calls. Deposit required to turn on phone in all rooms.

RAINY DAYS

Ask about other rainy day activities that may be going on.

DIRECTORY OF SERVICES continued

RESERVATIONS EXT. 0

We will be happy to make your advance reservations at any time. Please contact reservations or the front desk.

RESTAURANT EXT. 450

The Atrium Cafe & Bar is open for breakfast, lunch and lite fare. Frozen drinks available. Located inside Atrium on ground floor.

SHOWER & CHANGE FACILITIES EXT. 0

Available at no charge to our guests. Please inquire at the front desk.

ALL ROOMS HAVE IN ROOM SAFES

SWITCHBOARD EXT. 0

Open 24 hours a day.

WAKE-UP CALLS EXT. 0

YOUR ROOM

Your guest room is fully-equipped with towels, soap, toilet tissue, blankets (winter season) and other accessories according to your needs. We request that these accessories remain in the room. However, should you require additional accessories during your stay, please call the front desk.

HOTEL PHONE NUMBERS

DIRECTORY ASSISTANCE EXT. 0

..... DIAL 9 + 1 + (AREA CODE) + 555-1212

Directory Assistance for long distance numbers.

EMERGENCY EXT. 0

FRONT DESK EXT. 0

HOTEL OPERATOR EXT. 0

HOUSEKEEPING EXT. 0

LOST & FOUND EXT. 0

LONG DISTANCE CALLS EXT. 0

..... DIAL 9 + 0 + (AREA CODE) + NUMBER

Collect or credit card calls.

LONG DISTANCE CALLS EXT. 0

..... DIAL 9 + 1 + (AREA CODE) + NUMBER

Long distance calls charged to your room.

MANAGER ON DUTY EXT. 0

MESSAGE SERVICE EXT. 0

To leave or receive a message.

RESTAURANT EXT. 0

ROOM RESERVATIONS EXT. 0

WAKE-UP CALLS EXT. 0

LOCAL CALLS DIAL 9 + AREA CODE + NUMBER

LOCAL DIRECTORY ASSISTANCE DIAL 9 + 411

TIPS ON WHAT TO DO IN CASE OF A FIRE

1. If you discover a fire or smell smoke, sound the building alarm. The location of all fire alarm pull stations is illustrated in the diagram located on the back of your hotel room door.
2. Do not use the elevators. Elevators are like chimneys. Smoke could enter the elevator shaft, thereby asphyxiating anyone trying to evacuate the building, or become inoperative, trapping occupants.
3. Use the stairs. Calmly proceed to the nearest stairway.
4. If fire alarms sound, feel the door of your room before opening. If hot or smoke is seeping in, do not open. Use wet towels or sheets to seal off any cracks.
5. Fill the tub with water. It might be needed for firefighting.
6. Use the telephone in your room to call the hotel operator and let the operator know your room number
7. If door is cool, open cautiously. Be ready to close it rapidly if hall is full of smoke or you feel pressure against the door. If hall is clear, leave your room and close your door behind you. Proceed to the nearest exit.
8. When in smoke or heat, stay low where the air is better. Take short breaths (through nose) until you reach an area of safety.

LOCAL BUSINESS & RETAIL NUMBERS

EMERGENCY PHONE NUMBERS

Police - Fire - Ambulance	911
Marine Police	410-548-7070
Beach Patrol	410-289-7556
Coast Guard	410-289-7559

LOCAL INFORMATION

AAA	410-860-2885
Alcoholics Anonymous	410-600-5219
Chamber of Commerce	410-213-0552
City Hall	410-289-8221
Post Office - 71st Street	410-524-7611
Post Office - 408 Philadelphia Ave.	800-275-8777
Time	202-762-1401
Dial a Buoy / Marine and Weather Forecast (Coordinates: 38.3365° N, 75.0849° W)	888-701-8992
Western Union	800-325-6000

BANKS

M&T	410-208-4247
BB&T	410-524-7333
Bank of Ocean City	410-524-6144
SunTrust	410-213-5338
Bank of America	410-289-6818
Peninsula Bank	410-250-3000
Taylor Bank	410-289-8171

HEALTH CARE

Atlantic General Hospital	410-641-1100
A.G.H. Townsend Medical Center	410-289-6241
75th Street Medical Center	410-524-0075
West Ocean City Injury & Illness Center	410-213-0119

CHURCHES

Atlantic United Methodist 4th Street & Baltimore Ave.	410-289-7430
Baptist Chapel of Ocean City 12637B Ocean Gateway	410-289-6573
Holy Trinity Cathedral Rt. 113 at Rt. 90 Overpass	410-641-4882
First Presbyterian Church 13th Street & Philadelphia Ave.	410-289-9340
Worship Center (Assembly of God) 10736 Ocean Gateway	410-641-3325
Holy Savior Catholic Rectory 17th Street & Philadelphia Ave.	410-289-0652
St. Andrew's Catholic Center 144th Street Bayside	410-250-0300
St. Mary's Star of the Sea Catholic 208 Baltimore Ave.	410-289-0652
St. John Neumann Catholic Ocean Pines	410-208-2956
St. Luke's Catholic 100th Street & Coastal Highway	410-250-0300
St. Paul's By the Sea Episcopal 302 Baltimore Ave.	410-289-3453
St. Peter's Lutheran Church 10301 Coastal Highway	410-524-7474
St. George's Greek Orthodox 8805 Coastal Highway	410-524-0990
Episcopal of the Holy Spirit 100th Street & Coastal Highway	410-723-1973

CHURCHES (continued)

Berlin/Ocean City Lighthouse Church of God Sinepuxent & Lewis Road, West Ocean City	410-641-1171
Son'spot Ministries/Spirit Full Life Gospel 12 Worcester Street	410-289-1296
Temple Bat Yam/Daughter of the Sea Reformed Jewish Services Rt. 113, Berlin	410-641-4311

TRANSPORTATION

Taxi Taxi	410-289-8989
Greyhound / Carolina Trailways Bus	800-231-2222
Municipal Bus Information	410-723-1606
O.C. Municipal Airport	410-213-2471
Salisbury/Ocean City/Wicomico Airport	410-548-4827
American Airlines	800-433-7300
Enterprise Car Rental	410-213-0886

SHOPPING

Gold Coast Mall 114th Street & Coastal Highway	410-524-9000
Ocean City Outlets Rt. 50 & Golf Course Road	410-213-7898
Rehoboth Outlets Rt. 1, Rehoboth Beach, DE	302-226-9223
The Country House Salisbury, MD	410-749-1959

GOLFING

Glen Riddle	410-213-2325
Lighthouse Sound	410-641-1189
Eagle's Landing	410-213-7277
Nutters Crossing	410-860-4653
O.C. Golf & Yacht Club	410-641-1779
River Run	410-641-7200
Rum Pointe	410-629-1414

BOATING & WATERSPORTS

The Explorer - Boat Cruise	410-289-0004
Miss Ocean City - Deep Sea Fishing	443-353-0888
O.C. Princess - Deep Sea Fishing	410-289-6226
Off Shore Nature Cruise	410-213-0926
The Sea Rocket - Ocean Speedboat Ride	410-289-4386
White Marlin Marina	410-289-6470
O.C. Rocket - Speed Boat Ride	410-289-3500
Inlet Sea Doos	410-289-1488

SPORTS & RECREATION

Ocean Downs & Casino (harness racing)	410-641-0600
The Delmarva Shorebirds (baseball)	410-219-3112
Old Pro Golf (indoor miniature golf)	410-524-2645
Ocean Lanes (bowling)	410-524-7550

AMUSEMENTS & ARCADES

Baja Amusements	410-213-2252
Frontier Town - Wild West Theme Park	800-228-5590
Trimper Amusements - Boardwalk	410-289-8617
Fun City Arcade	410-289-4133
Marty's Playground Arcade	410-289-7271
Jolly Roger	410-289-3477



LOCAL BUSINESS & RETAIL NUMBERS continued

THEATRES

Gold Coast Theatre 410-213-1505
 Sun & Surf Cinemas 410-250-1777
 Flagship Premium Cinemas 443-664-7554

BOARDWALK TRAIN Summer Schedule Runs the length of the Boardwalk every 20 minutes for a nominal fee.

MUNICIPAL BUSES

City buses run seven days a week from the Inlet to the Delaware State line. The buses leave approximately every 5 minutes from 6:00AM to 2:00AM. The buses leave every 30 minutes from 2:00AM to 6:00AM. \$3 for an all day pass. This is the summer schedule, please call 410-723-1606 for the winter schedule.

LOCAL ATTRACTIONS

OCEAN CITY LIFE SAVING STATION MUSEUM

In Ocean City, MD at the Inlet & Boardwalk
 Originally built in 1891, this museum was the actual home to the United States Life Saving Service for several years. Exhibits include aquariums, shipwrecks, artifacts, doll houses, programs, photographs and numerous small exhibits. Weekly educational programs for groups are available in July and August. For information call 410-289-4991

WARD MUSEUM OF WILDFOWL ART

In Salisbury, MD, 35 minutes west of Ocean City on Rt. 50. See wood come alive in this unique display of wildfowl carvings representing the top works of the finest contemporary carvers and the best classic hunting decoys in the nation. Open year round. For information call 410-742-4988.

JULIA A. PURNELL MUSEUM

In Snow Hill, MD, approximately 40 minutes south of Ocean City on Rt. 113. A showcase of area lore from Indian and Colonial times to the Victorian era; artifacts from the medical, cooking, farming, sewing and clothing areas housed in a quaint historic structure. Open year round. For information call 410-632-0515.

NASSAWANGO IRON FURNACE

In Snow Hill, MD, approximately 40 minutes south of Ocean City on Rt. 113. 1840's industrial village re-created; includes narration on Furnace Town buildings (country shop, museum, blacksmith, woodwork, broom making, print shop and more), iron furnace and grounds. Open year round. For information call 410-632-2032.

CHESAPEAKE BAY MARITIME MUSEUM

In St. Michaels, MD, approximately 1 hour west of Ocean City on Rt. 50. Explore 16 acres of exhibits on the history of the Bay and its traditions in boat building, commercial fishing, yachting, waterfowl and navigation. Special feature is the 100 year old Hooper's Strait Lighthouse. Open year round. For information call 410-745-2916.

OCEAN CITY OUTLETS

In West Ocean City, MD, Rt. 50 & Golf Course Road
 Ocean City's premier shopping center featuring 40 of the nation's top brand name manufacturers. Save 20-70% off regular retail prices. Preferred shopper cards are available for a discount. Open year round. Closed Easter and Christmas Days. For information call 410-213-7898.

SALISBURY ZOO

In Salisbury, MD, 35 minutes west of Ocean City on Rt. 50. See the many exhibits the Salisbury Zoo has to offer. Learn about bears, monkeys, jaguars, waterfowl and much more. For more information call 410-548-3188.

SMITH ISLAND CRUISES

In Rhodes Point, MD, approximately 1 1/2 hours southwest of Ocean City. Smith Island is Maryland's only inhabited island accessible exclusively by boat. Stroll the island, take a bus tour or visit the new museum. Lunch can be included. Cruise time: 1 1/2 hours. Seasonal. For information call 410-425-2771

BAY CRUISES

In Crisfield, MD, approximately 1 hour southwest of Ocean City. Take a ride on one of the large Bay Cruise Boats to and from Tangier or Smith Island discovered by Captain John Smith in the 1600's. Seasonal. For information call 410-968-2338.

OCEAN DOWNS CASINO

In Berlin, MD, approximately 10 minutes away from Ocean City on Rt. 50 & 589. Featuring live and simulcast harness racing, dining, table games and slot machine entertainment. The Clubhouse offers special group rates and events as well as dinner and buffets. Have a race named in the honor of your group, and if you win, you'll stand in the winner's circle. Seasonal. For more information call 410-641-0600.

THE DELMARVA SHOREBIRDS

In Salisbury, MD, approximately 35 minutes west of Ocean City on Rt. 50. The Shorebirds are a Class A affiliate of the Baltimore Orioles, and were the South Atlantic League Champions in 1997. The state-of-the-art Arthur W. Perdue Stadium offers several outdoor cafes, numerous concession stands and a playground. Seasonal. For more information call 410-219-3112.

ASSATEAGUE NATIONAL PARK

In Assateague Island, MD, approximately 40 minutes south of Ocean City. The southern most part of the natural barrier reef, stretching from the Ocean City inlet to the Virginia border. Miles of beach and dunes protected as a national park. Wild ponies, nature trails, picnic areas, fishing and boating. Beach and special programs are available. Open year round. For more information call 410-641-1441.

CHINCOTEAGUE WILDLIFE REFUGE

In Chincoteague, VA, approximately 50 minutes south of Ocean City on Rt. 113. Nature at its finest, home of many endangered species in this lush refuge featuring Chincoteague ponies, many wildfowl species, deer and more nestled between the Atlantic Ocean and Chincoteague Bay. Open year round. For information call 757-336-6122.

HOTEL LAYOUT

FIRST FLOOR

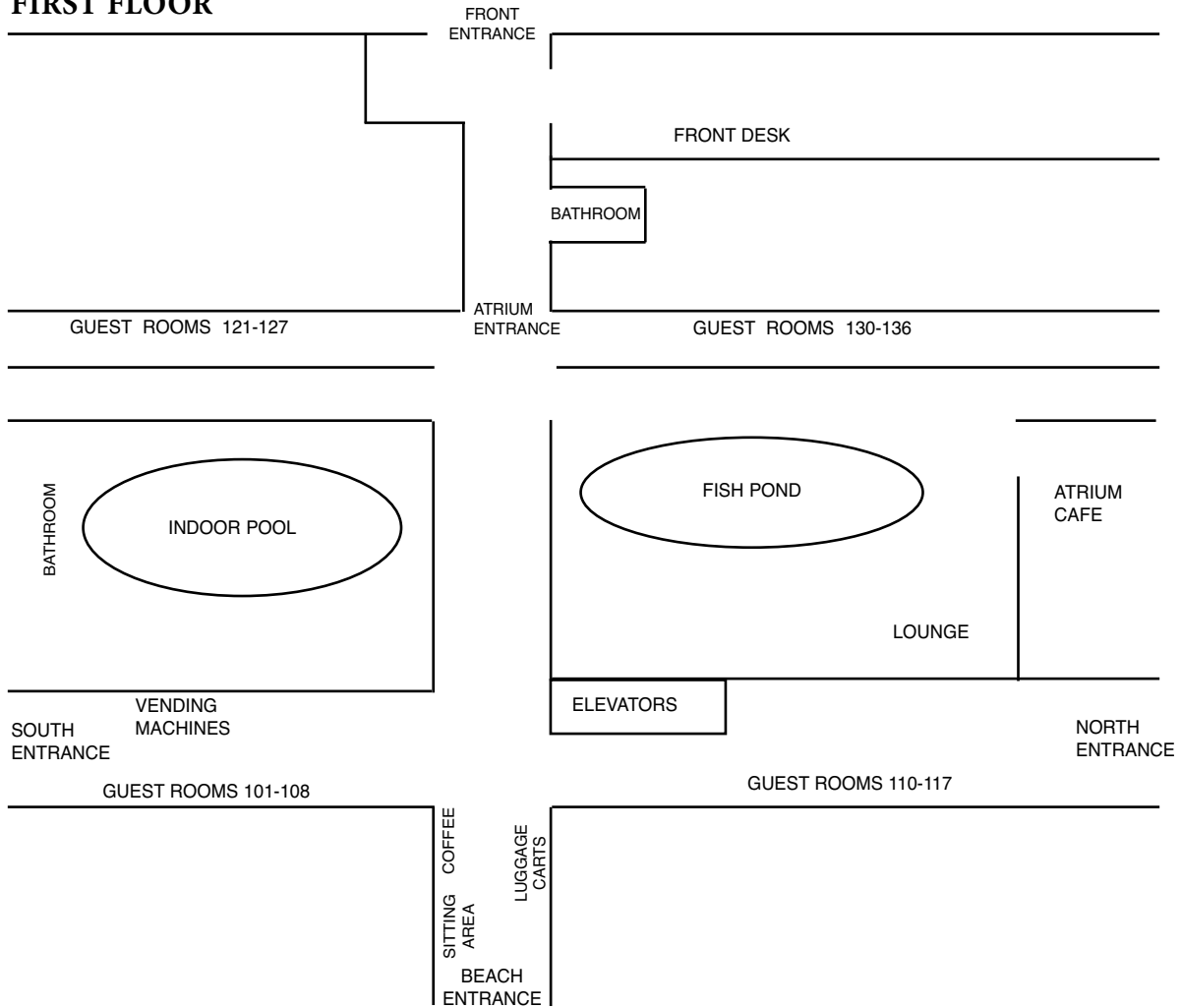

2ND FLOOR OCEANFRONT

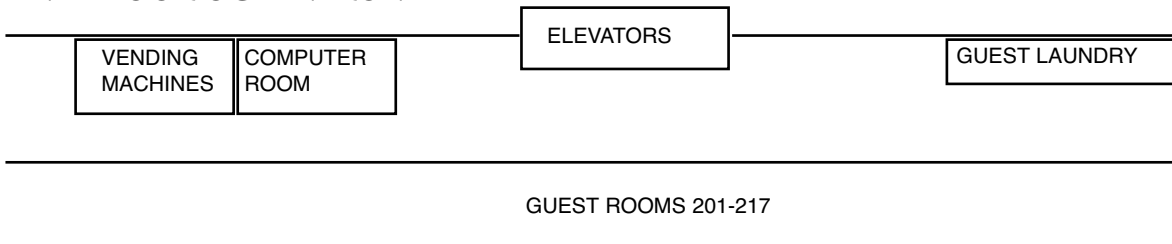

BASEMENT

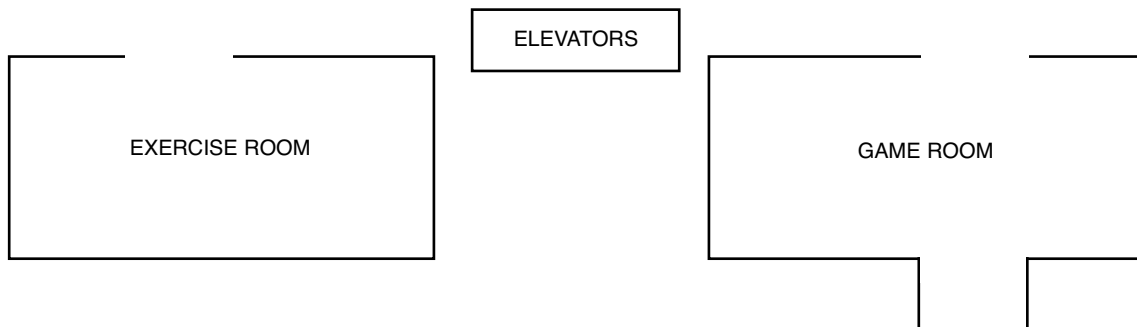

IN HOUSE DINING

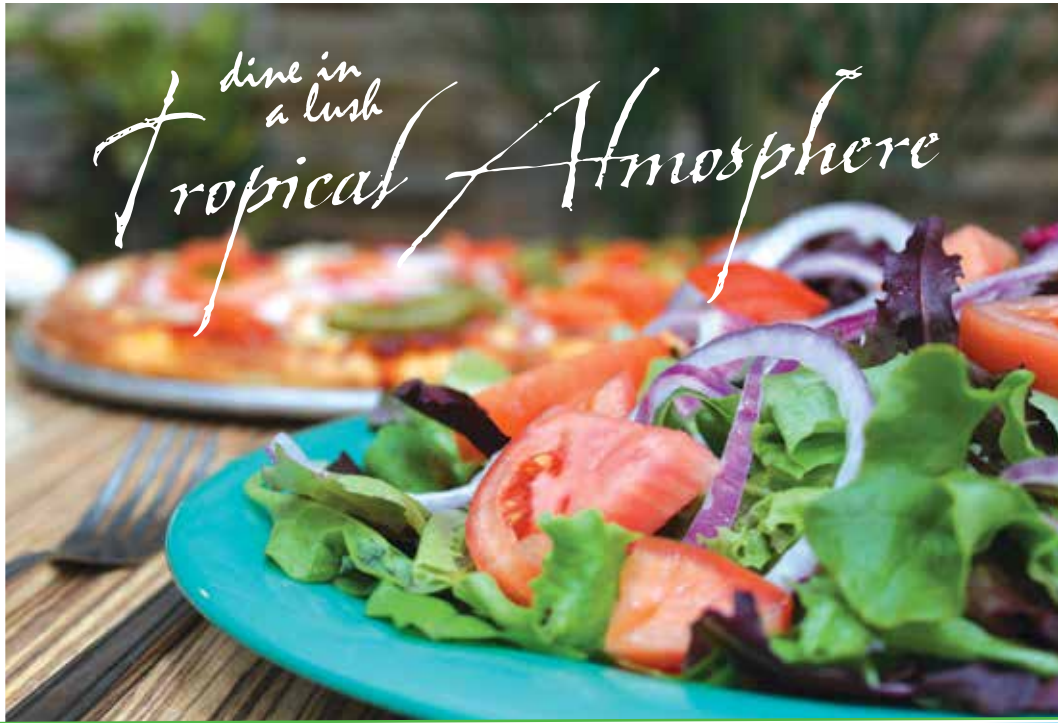

A FULL SERVICE RESTAURANT IN A TROPICAL ATMOSPHERE,

Serving up Breakfast, Lunch and Dinner

breakfast: eggs, omelets, pancakes, breakfast sandwiches...

lunch: pizza, sandwiches, wraps, burgers, baskets, wings, salads...

dinner: appetizers, shrimp, steak, chicken, fish of the day...



Enjoy happy hour every day with our signature tropical drinks and great food specials.

ATRICUM
Cafe & Bar

54th St. in the Quality Inn | 410-723-1646 | qioceanfront.com/dining



APPETIZERS & SIDE ORDERS

Served daily 11:30am - 9:30pm

STUFFED JALAPENO POPPERS 6.99
MOZZARELLA STICKS 6.99
CHICKEN TENDERS 6.99
FRIED GREEN BEANS 6.99
BUFFALO WINGS 8.99
FRENCH FRIES 3.99
ONION RINGS 4.99
FRIED PICKLES 6.99

DINNERS

Served daily 4:30 - 9:30pm. All entrees are served with French Fries and a small salad

SHRIMP	Fried shrimp 12.99
CHICKEN BREAST	10 ounce charbroiled chicken breast. Your choice of Cajun, BBQ or Teriyaki	. 13.99
CLAM STRIPS	8 ounces lightly breaded and deep fried 12.99
CHEF SALAD	Traditional chef salad topped with mozzarella & served with your choice of dressing 9.99
HOUSE SALAD	A bed of greens topped with red onions and tomatoes & your choice of dressing	. 6.49
HOUSE SALAD W/ CHICKEN BREAST	 10.99
HOUSE SALAD W/ TUNA SALAD	 9.99
HOUSE SALAD W/ FISH OF THE DAY	 market

ATRIUM

Cafe & Bar

410-723-1646

54th Street in the Quality Inn Oceanfront
Staying in the Hotel? Dial 450 for Carryout

BEER

Draft 3.00 ~ Miller Lite • Yuengling Lager

Domestic 3.75 ~ Coors Light • Natural Light
Budweiser • Bud Light • Miller Lite
Michelob Ultra • O'Douls

Imports 4.75 ~ Heineken • Corona • Corona Light
5.50 ~ Guinness Pub Draft

WINE

By the Glass 5.50

Merlot • Chardonnay
White Zinfandel • Pinot Grigio

FROZEN DELIGHTS

7.50

Strawberry Daiquiri • Banana Daiquiri
Toasted Almond
Black Raspberry, Pina, Melon,
Strawberry and Raspberry Coladas
Rootbeer Float • Mint Chocolate Chip
Blue Hawaiian • White Russian • Mudslide
Peach Fuzz • Strawberry Margarita
Brandy Alexander • Almond Joy
Jamaican Delight • Creamsicle • Dirty Banana

RUM RUNNERS

8.00

COFFEE DRINKS

7.00

Italian Coffee (Amaretto) • Irish Coffee (Jameson)
Jamaican Coffee (Tia Maria)
Mexican Coffee (Kahlúa)

BEVERAGES

Coke, Diet Coke, Sprite, Ginger Ale, Iced Tea
(1 size, 1 refill) **2.75**

Bottled Water or Milk **1.99**

Coffee, Decaffeinated Coffee or Tea **2.00**

Juice - orange, grapefruit, cranberry, pineapple,
tomato, apple small 2.00 / large **2.75**

BREAKFAST

Served daily 8:30am - 11:30am

2 EGGS with sausage or bacon 6.29

PANCAKES 5.79

FRENCH TOAST 5.79

BACON OR SAUSAGE 2.50

TRIO COMBO 6.99

One each: pancake, egg and choice of bacon or sausage

BLT 6.99

HASH BROWN 1.25

ENGLISH MUFFIN 1.29

TOAST99

BAGEL & CREAM CHEESE 2.79

OMELETS

HAM & CHEESE 8.99

BACON AND CHEESE 8.99

SAUSAGE AND CHEESE 8.99

CHEESE OMELET 6.99

PIZZA

Toppings: ham, bacon, pepperoni,
sausage, onion, tomato, jalapenos

6" PIZZA 5.99 • Toppings 50¢ each

12" PIZZA 12.99 • Toppings 1.00 each

16" PIZZA 15.99 • toppings 1.50 each

SANDWICHES & WRAPS

Served with chips daily 11:30 am - 9:30

Add French Fries 1.99. Add Onion Rings 2.49,

Add a Wrap 1.00.

*Your choice of lettuce, tomato,
mayonnaise, onions and pickles*

CHEESE STEAK Chicken or Beef 8.99

***HAMBURGER** 7.99

***CHEESEBURGER** 8.49

***BACON CHEESEBURGER** 9.49

GRILLED CHICKEN BREAST 8.50

GRILLED BBQ CHICKEN BREAST 8.99

GRILLED CAJUN CHICKEN BREAST ... 8.99

BLT 6.99

HAM & CHEESE 6.99

CLUB SANDWICH 8.99

GRILLED CHEESE 4.79

HOT DOG - 1/4lb 5.99

BASKETS (INCLUDES FRIES)

CHICKEN TENDERS 7.49

FRIED SHRIMP 7.49

FISH-N-CHIPS 7.49

CLAM STRIPS 7.49

WING DING 7.49

This establishment takes Great Pleasure in donating a percentage of its Food and Non-alcoholic Beverage sales to United Way of the Eastern Shore.

Thank you for your support and patronage. *\$1 from every Tito's cocktails sold will be donated by Tito's handmade vodka to the United Way of the Lower Eastern Shore on behalf of this establishment.

*Consuming raw or undercooked meat, poultry, seafood, shellfish or eggs may increase your risk of contracting a food borne illness, especially if you have certain medical conditions.